

Crossway LE Cursor 8 Euro III

C R O S S W A Y L E



length	11.995 mm
width	2,550 mm
Height (without air conditioning)	3 145 mm
wheelbase	6,030 mm
front/rear overhang	2.673 / 3.292 mm
Front/centre door width	1,200/ 1,200 mm
Internal height	2547/2080mm
access height front/rear	320/ 330 mm
turning radius	9,550 mm
scanning beam	11,100 mm
Approach angles	7°/7°
GVW	18,000 kg
max. load Per axle	11,500kg/6,500kg

Crossway LE Cursor 8 Euro III

BODYWORK AND EXTERIOR EQUIPMENT

- Welded frame with U-shaped longitudinal members and tubular cross members
- Sidewall structure made of tubes
- Pressed sheet metal front panel spot welded + composite
- Composite rear panel
- 3-part front bumper
- Deep-drawn steel profile roof
- Anti-corrosion protection by cathophoretic dipping, supplemented by primer and topcoat based on polyurethane resins
- 1,200 mm external 2-leaf swing front door
- 1,200 mm external 2-panel swing door
- Manually adjustable, heated exterior mirrors
- Paint and adhesive cuts DDD
- frame for front panel display: 1400x320 mm
- frame for left display: 3890 x 1000 mm
- frame for standard display right: 2120 x 1000 mm
- rear display frame: 998 x 845 m

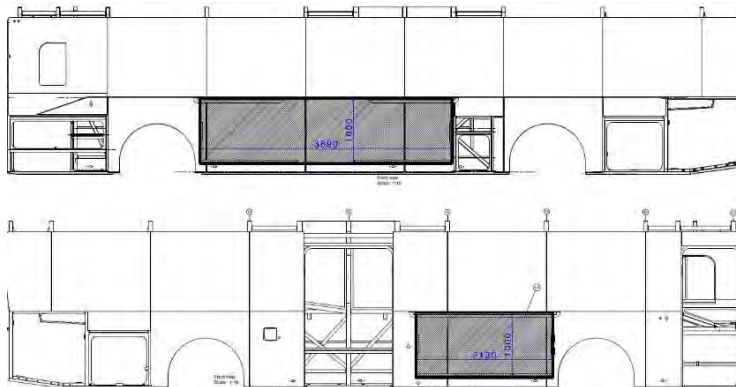

INTERIOR FITTINGS

- STER 8MS grey plastic seats

Crossway LE Cursor 8 Euro III

- Seating arrangement 34 seats + 1 cab guide + 1 driver (total 106 passengers max. according to local regulations)

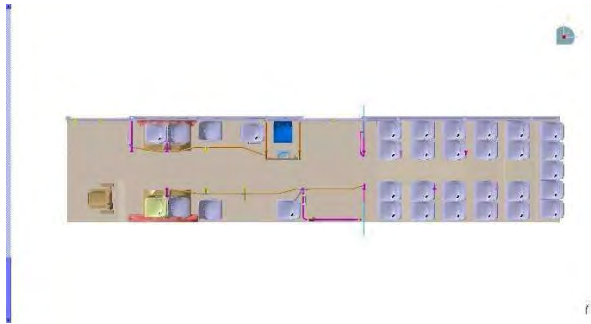

- Receiving station
- Passenger compartment lighting
- Non-slip floor and stair treads
- Laminate headliner
- Laminated panel side panels
- Laminate divider upholstery
- 4 PRM seats
- Manual UFR ramp
- Enlarged internal mirror
- Ice-breaking hammer
- Bars and handrails in yellow RAL 1018

ELECTRICITY

- Accumulator batteries 230 AH/1250 A
- Alternators 2 X 90A
- 12 V socket in dashboard

Crossway LE Cursor 8 Euro III

- Electrical cabinet in front left boot with fuses
- Brake light and indicator repeaters on the upper part of the rear face
- Illuminated "stop requested" box with 4 call buttons
- Clearance lights
- Reverse noise generator
- Front fog lamps

BAYS / THERMAL COMFORT

- Sliding tinted passenger side windows
- Thermal and sound insulation of the side panels / roof / front panel / engine compartment
- 2 opaque roof vents at the front and rear of the vehicle, manually operated
- Without passenger heating

OPERATING SYSTEM

- Pre-arrangement / wiring for validator + plate on dashboard for subsequent installation of a ticketing system (See Annex A-2: synoptic)
- Hanover front, side and rear LED windvanes



Girouette frontale 144x19 ambre

Girouette latérale 96x15 ambre

Girouette arrière 96x15 ambre

- Pupitre Eric G3 base

- Dual 21" LCD screens positioned in the middle of the bus
- Supply and installation of WiFi CIBEST L 110 (excluding SIM card)
- Predisposition for data download LCD screen via WiFi
- 8 USB ports for passengers

Crossway LE Cursor 8 Euro III

- Receiver's cabin (See photo below)

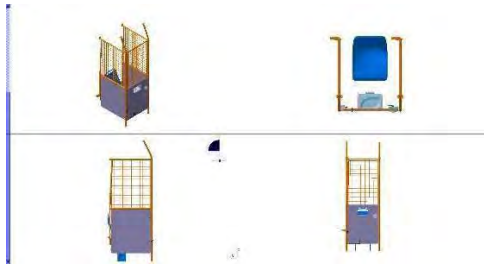

- Predisposition for the installation of a ticketing system according to the client's information. Dakar Dem Dikk will be responsible for the choice of the ticketing system.

DRIVING POSITION

- Standard driver's seat with air suspension and belt
- Divider behind driver with top window
- Lockable driver's luggage door
- Manual front sunshade
- Without Controller
- Anthracite grey driver's seat upholstery
- Push button engine start (not key start)

ENGINE

- IVECO CURSOR 8 EURO III
- Vertical 6-cylinder diesel engine, common rail injection
- Maximum power 228kw (310hp)
- Engine speed 2050 rpm
- Hydrostatically driven fan - Oil temperature exchanger
- Cold start by resistance integrated in the intake manifold
- Reinforced dual cartridge air filter
- Fire detection in engine compartment

GEARBOX

- Automatic gearbox VOITH D 864.5

Crossway LE Cursor 8 Euro III

REAR DECK

- MERITOR U17X rear axle with single central reduction
- Short bridge ratio 4.63
- Maximum speed: 85 km/h

FRONT AXLE / STEERING

- IVECO front axle type RI-75 with independent wheels
- ZF/Bosh Steering Type 8098

SUSPENSION

- Integral tyre with levelling system
- Front: 2 cushions / 2 shock absorbers / 1 stabiliser bar / 1 levelling valve
- At the rear: 4 cushions / 4 telescopic shock absorbers / 4 retaining rods / 1 stabiliser bar / 2 levelling valves
- Kneeling device on the right
- Bus raising device
- Standard shock absorbers

COMPRESSED AIR

- Twin-cylinder air compressor
- Air dryer; bleed valves on air tanks

BRAKES

- Pneumatically operated service brakes, front & rear discs
- Anti-lock braking system A.B.S.
- Parking brake
- Emergency brake provided by independent circuits
- Door brake on front and middle door opening

Crossway LE Cursor 8 Euro III

ROLLER

- Hydraulic retarder integrated in the gearbox

FUEL TANK

- 200 lt fuel tank with right-hand filling and lockable hatch

WHEELS AND TYRES

- Tyres size 275/70 R 22.5
- Front wheel nut protectors
- Wheel flaps
- 1 Spare wheel delivered in bulk