

## Contents of this configuration

Contents of this configuration	2
Vehicle description	3
Vehicle Standard data	3
Permissible Weight	3
Configuration for: TGL 8.160 4X2 BB / LN03KA01	5
Colours	25
Drive line: TGL 8.160 4X2 BB / LN03KA01	26
Vehicle data Drive line	26
Results Drive line	27
Chassis drawing: LN03KA01 / TGL 8.160 4X2 BB	28
Technical data: TGL 8.160 4X2 BB / LN03KA01	29

## Vehicle description



Similar to illustration, may include special equipment that is subject to a surcharge

## Vehicle Standard data

Variant description	TGL 8.160 4X2 BB
Basic vehicle	LN03KA01
Number	
Emission class	EURO4
Vehicle type	Three-way tipper
Cab	C Cab
wheelbase	3050 mm
Overhang	1075 mm
Steering layout	Left

## Permissible Weight

	NATREG	TECHN	TECH+
<b>Total weight</b>	8800 Kg	8800 Kg	8800 Kg
<b>Perm. Total weight</b>	0 Kg	0 Kg	0 Kg
<b>Front axle</b>	3400 Kg	3400 Kg	3400 Kg
<b>Rear axle</b>	5600 Kg	5600 Kg	5600 Kg

**Key**

NATREG : National permissible weights

TECHN : Technically permissible weights

TECH+ : Technically permissible weights including additional load for special deployment

**Configuration for: TGL 8.160 4X2 BB / LN03KA01**

Explanation: ■ = Equipment

**Engine Cooling  
System Clutch**

- Engine D0834LFL92 - 160 hp / 118 kW Euro 4 SCR - 600 (018R3)  
Nm C-R without torque reduction

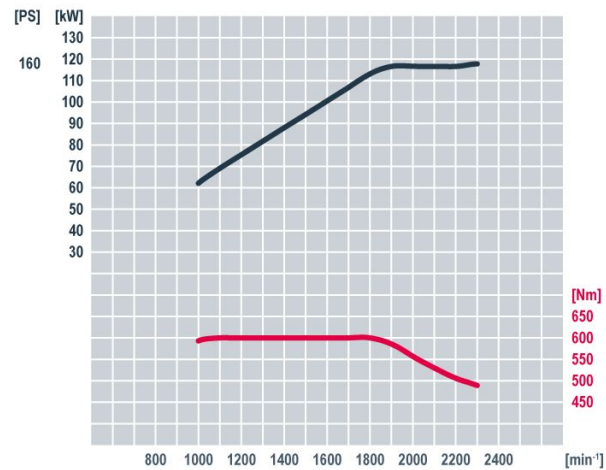

- Engine number also on crankcase (118AP)

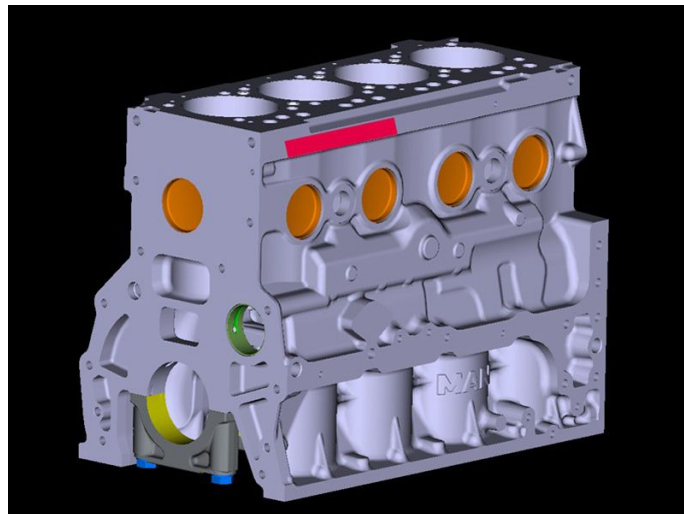

- Auxiliary fuel filter with water separator

(124AZ)



- connection for external engine speed control (ZDR)

(203EK)

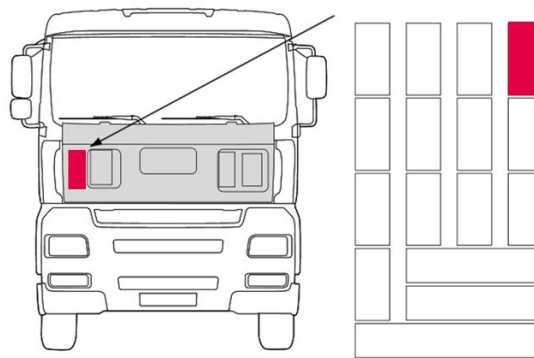

- Control module for external data exchange (customer-specific control module) with body functionality

(203ER)

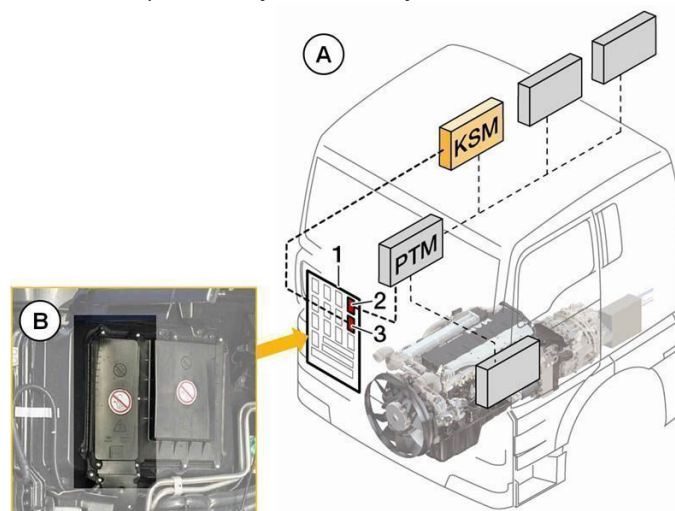

- exhaust valve brake

(208AK)

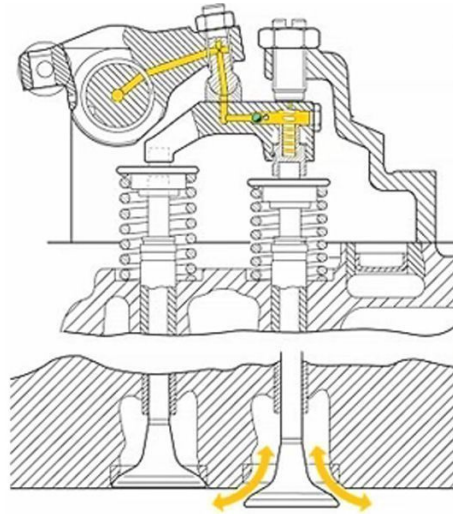

- flame starting system

(210AA)



- Cruise control

(345EA)



- International data confirmation

(542DC)

## Intake / Exhaust System

- Supplier declaration (542DM)
- anti-noise measures are not in accordance with EU standard (542FX)
- confirmation for international registration (542IZ)
- air intake upswept with dry air filter behind cab / precleaner (201CR)

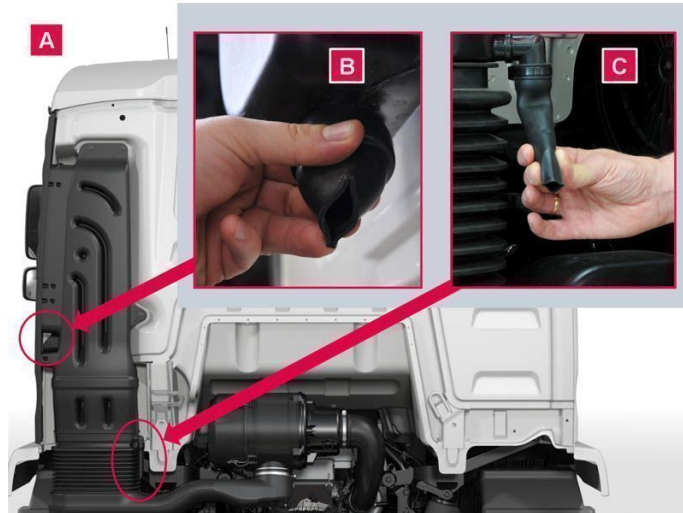

## Power Take-Offs

- PTO NH/1C without flange  $f=0.53$  (122HD)

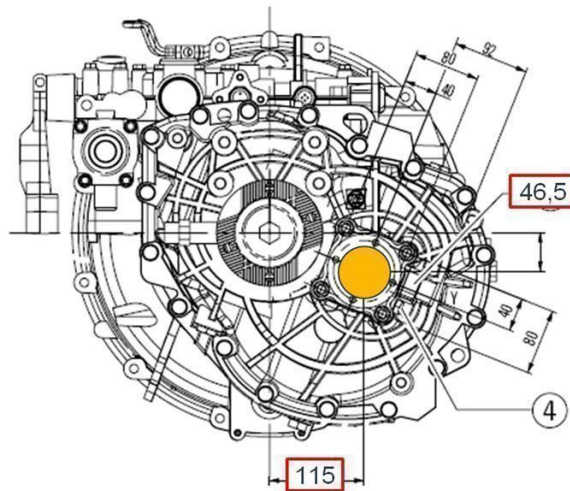

- MEILLER axial pump 254/1

(133EL)



- actuating system for tipper body

(133MA)



Front Axle / Front  
Springs / Front Axle  
Load

**Rear Axle / Rear  
Springs / Rear Axle  
Load**

- front springs parabolic 3.4 t

(026FX)

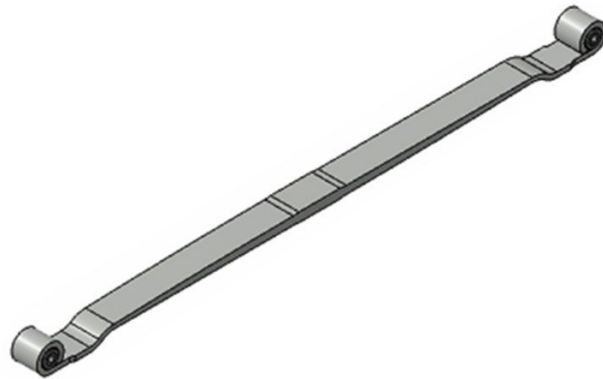

- rear springs parabolic 5.6 t

(028FS)

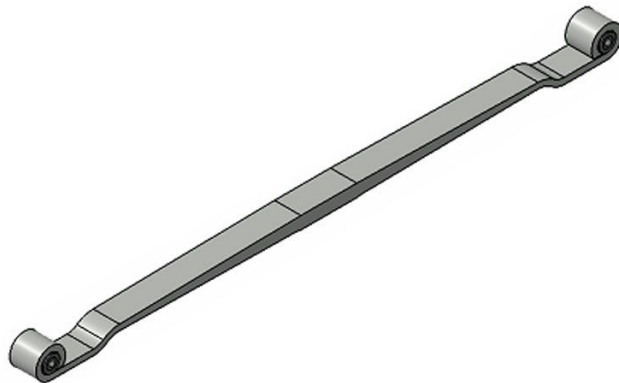

- Caution: Rear springs uprated to maximum

(028ZA)

- with differential lock in rear axle

(037AC)

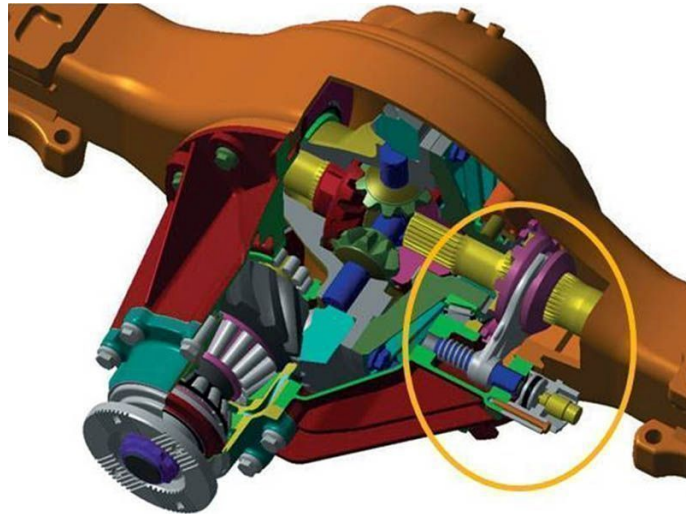

- Stabiliser for rear axle

(362AA)

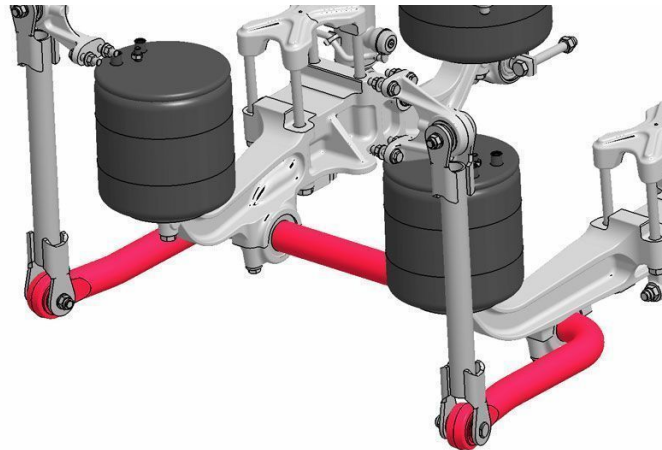

#### Transmission ratios

- Hypoid axle ratio  $i = 3.36$

(035HA)

#### Rims

- disc wheel 6-hole 6.00-17.5 as spare wheel TL

(038UV)



- spare-wheel holder on left side (245AE)

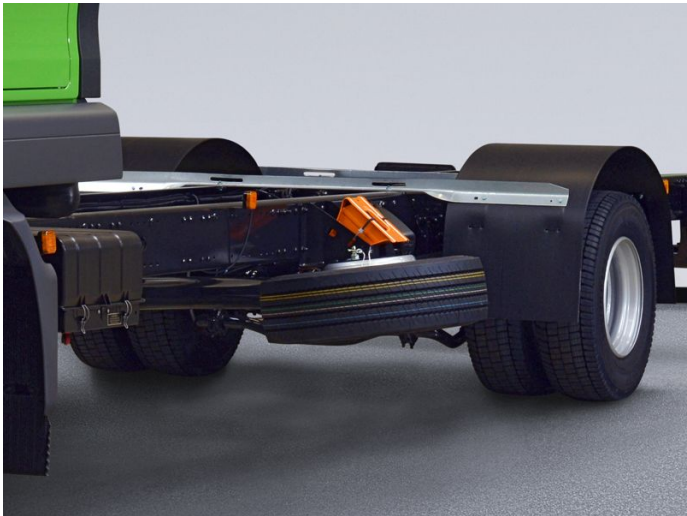







- Tyre load rating increased by 10% municipal allowance (799RK)

Tyres

- Front axle ■ 2 \* WA 215/75R17,5 LENK-NAH TL 126/124 M  
81#R0000807 wahlweise Strg-Sh
- Rear axle ■ 4 \* WA 215/75R17,5 ANTR-NAH TL 126/124 M  
81#R0000808 wahlweise Drive-Sh
- Spare tyre ■ 1 \* WA 215/75R17,5 LENK-NAH TL 126/124 M  
81#R0000807 wahlweise Strg-Sh

Label

	 Fuel efficiency class (A-G)	 Wet grip class (A-G)	 Rolling noise	Rolling noise class (1-3)
Front axle	D	C	72 dB	
Rear axle	D	C	74 dB	
Spare tyre	D	C	72 dB	

Fuel Tanks

- strainer for fuel tank

(123CC)



## Steering

- steering oil reservoir with dipstick

(219AF)

## Frame

- front underride guard

(230ER)

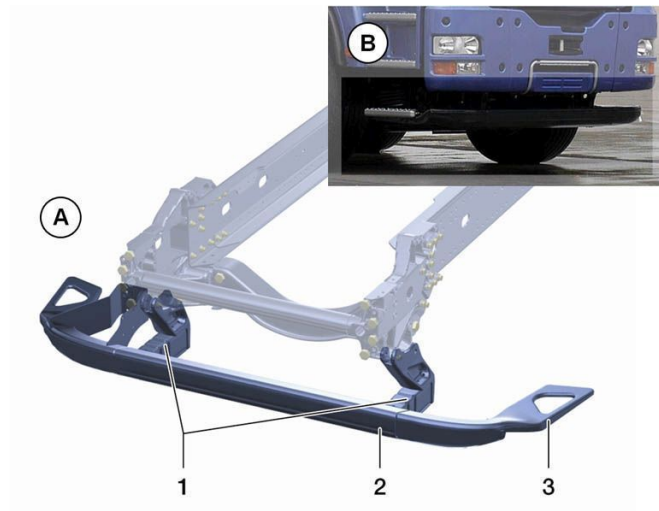

- Without rear underride guard

(230XX)

- steel bumper

(233EK)



- rear cross member for trailer coupling 140X80

(236CR)

- body mounting brackets on frame

(241AE)

- radiator guard

(241CA)



**Trailer/Fifth-wheel  
Coupling**

- tow coupling RINGFEDER 6441

(234EB)



**Cab exterior**

- Central locking

(321EC)



- Mechanical lifting roof

(386AS)

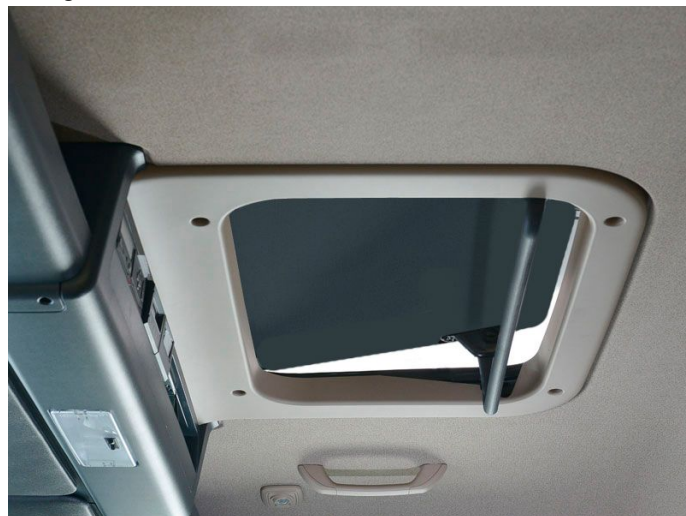

- Sun shade in front of windscreen

(388AK)



- Kerb mirror, right, heated and electrically adjustable

(392AR)



- Electrically heated and adjustable rear view mirror, heated wide-angle mirror

(392CZ)



- spray reducer

(404AP)



## Cab interior

- driver's seat, high-comfort, with air suspension

(058NH)

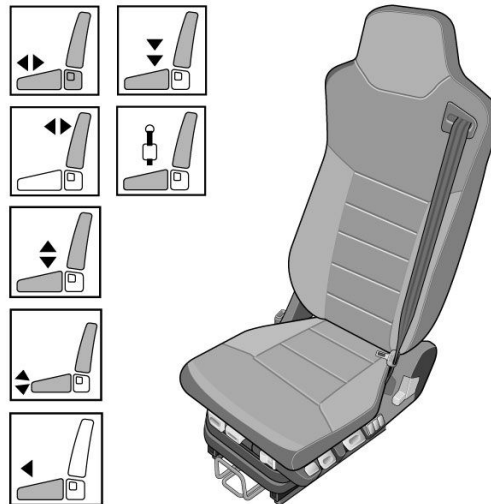

- co-drivers' bench for 2 persons (single seats)

(059CD)



- door interior panelling washable

(080AE)



- air conditioning system AC R134A without CFHC

(153KA)

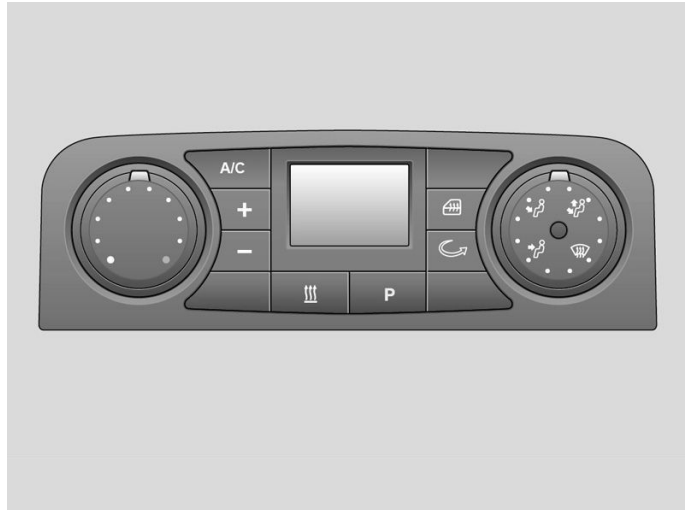

- Electric door window lifters for driver and co-driver

(387AF)



**Instruments**

- pigeon hole on rear wall lhs (390CW)



- Signs in English (523AC)
- without electronic tachograph (042XY)



- Language 1 'English' for display in instrument panel (325EC)
- Language 2 'Arabic' for instrument panel display (325KU)

- Acoustic warning system for engaged reverse gear, can be deactivated (343CK)



## Lights

- Switches and wiring for cargo space lighting (320AC)



- 2 halogen revolving beacons on cab roof left and right (352CF)



- Revolving beacon, yellow

(352WS)

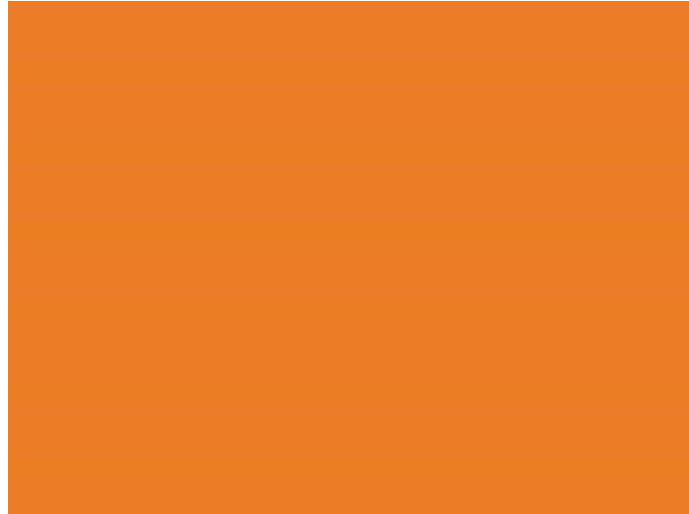

## Electrical System

- Smoking package

(434CH)



## Other

- operator's manual in ARABIC

(194CC)

- preservation for transport overseas

(195AG)



- antifreeze effective down to -35 degrees

(373AE)



- 37°C

- 1 Fire extinguisher, 2 kg, multilingual (English/German/Dutch)

(394FM)



- plastic mudguards (full) rear

(401CH)



- 20 m tyre inflator hose with pressure gauge

(405CP)



- Jack 12 t

(407AH)

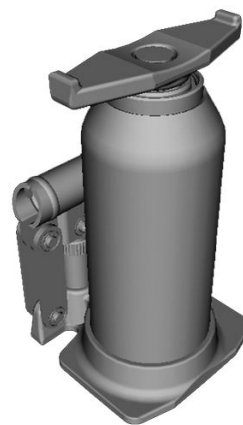

- 1 chock

(411AA)

## Operation and Country-specific Items

- General PTO parameterisation (119EH)

119EH TGL- TGM						
	voreingestellte Arbeitsdrehzahl		untere Drehzahlgrenze		obere Drehzahlgrenze	
	pre-set speed		lower speed limit		upper speed limit	
	manual gearbox	TipMatic®	manual gearbox	TipMatic®	manual gearbox	TipMatic®
<b>ZDRS</b>	1000	1000	500	800	1300	1300
<b>ZDR1</b>	900	900	800	500	1300	1300
<b>ZDR2</b>	950	950	800	500	1300	1300
<b>ZDR3</b>	1000	1000	800	500	1300	1300
<b>ZDR4</b>	750	750	550	500	1300	1300
<b>ZDR5</b>	950	950	800	500	1300	1300
<b>ZDR6</b>	800	800	550	500	1300	1300
<b>ZDR7</b>	600	600	600	500	600	600

## Body

- MEILLER tipper body 3,800x2,350 (485QH)



## Foils and decoration



- Reflective contour marking for cab, white (196KF)

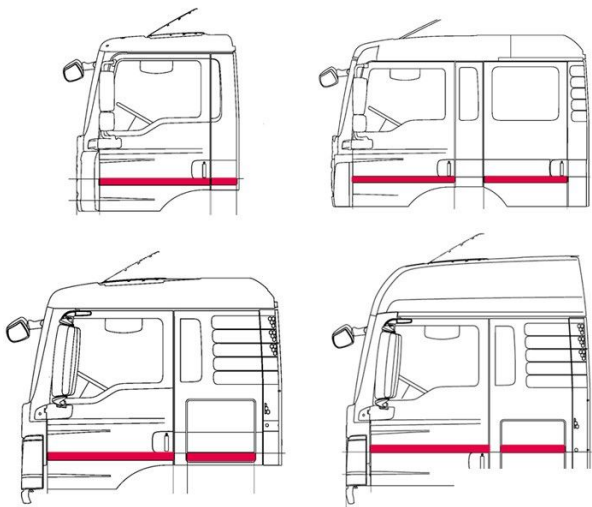

Colours

chassis	■ 9011 graphite black RAL 9011 matt	W
wheels	■ 9006 White aluminium acrylic RAL 9006	N
cab	■ 9010 Pure white RAL 9010	N

## Drive line: TGL 8.160 4X2 BB / LN03KA01

### Vehicle data Drive line

<b>Transport task</b>	Application	Street
	Road speed	89 km/h
	Truck Combination	Solo vehicle
	Driving surface	Asphalt street
	tyre profile	Normal
<b>Engine</b>	Name	Engine D0834LFL92 - 160 hp / 118 kW Euro 4 SCR - 600 Nm C-R without torque reduction
	Power	160 HP (118 kW)
	Economy band	1620-1800 [rpm]
	Max. RPM	2300 [rpm]
<b>Gearbox</b>	Name	Transmission ZF 6S-800 OD
	Ratio	6,58-0,78
	1   6.58	5   1.0
	2   3.6	6   0.78
	3   2.12	
	4   1.39	
<b>Rear axle</b>	max. permissible total weight	0 Kg
	Gears (forward/reverse)	6/1
	Name	hypoid rear axle HY-0718
	Construction type	Hyp
	Load capacity	8400
<b>Tyres rear axle</b>	Ratio	3.36
	max. permissible total weight	18750 Kg
	Name	WA 215/75R17,5 ANTR-NAH TL 126/124 M
	Diameter	768.0 mm
	Circumference	2343.0 mm
	Load capacity single/twin (axle)	3400/6400 Kg

## Results Drive line

## RPM for rating speed

RPM for rating speed (89 km/h) 1660 [rpm]

## Remaining gradability

In the largest gear for Road speed 3.9 %

## Traction

Slipping barrier Asphalt street 38 %

## Speed

## Speed in km/h (Street gears)

Gear	Ratio at max. speed	at 1000 rpm	Gear	Ratio	at max. speed	at 1000 rpm
1	6.58	15.2	4	1.39	72.0	30.1
2	3.6	27.8	5	1.0	100.1	41.8
3	2.12	47.2	6	0.78	128.3	53.6
R1	6.06	16.5				

## Speed in km/h (Street gears)

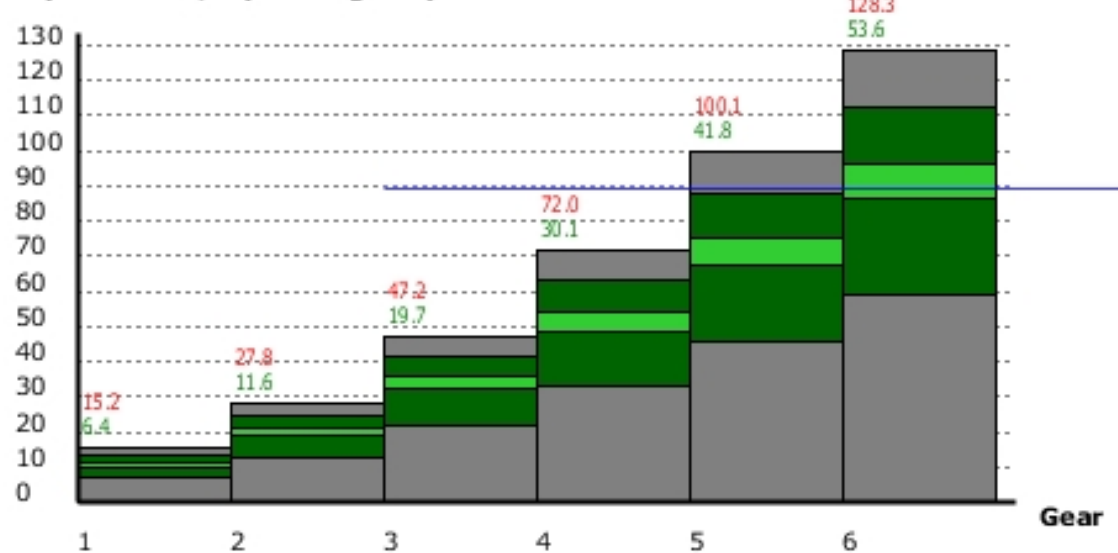

Chassis drawing: LN03KA01 / TGL 8.160 4X2 BB

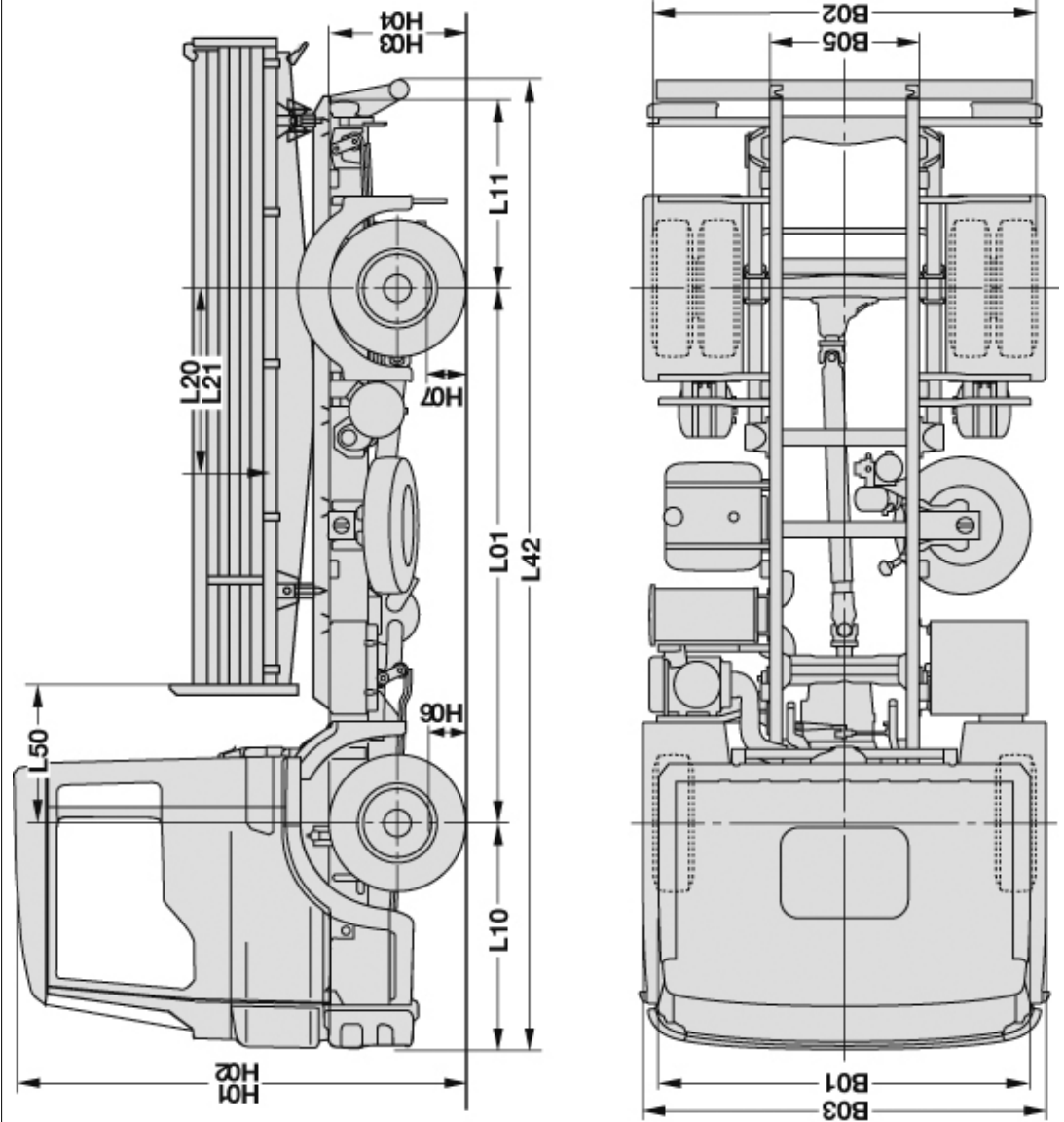

The displayed chassis drawing is only symbolic and can differ from the ordered vehicle.

**Technical data: TGL 8.160 4X2 BB / LN03KA01**

Vehicle type: Three-way tipper

C Cab

Drive configuration: 04X02

**Tyres**

Front axle: WA 215/75R17,5 LENK-NAH TL 126/124 M  
 Rear axle: WA 215/75R17,5 ANTR-NAH TL 126/124 M

**Length**

L01: Wheelbase from 1. - 2. Axles	3050.0
L02: Wheelbase from 2. - 3. Axles	0.0
L03: Wheelbase from 3. - 4. Axles	0.0
L04: Wheelbase from 4. - 5. Axles	0.0
L05: Wheelbase from 5. - 6. Axles	0.0
L09: Theoretical wheelbase	3050.0
L10: Vehicle overhang front	1293.0
L11: Vehicle overhang rear	1075.0
L12: 1. Wheel centre to first frame bend	0.0
L13: 1. Wheel centre to second frame bend	0.0
L14: Frame length behind cab	3635.0
L20: Body centre of gravity to	569.0
L21: Body centre of gravity from	-279.0
L22: Body centre of gravity executed, Truck	0.0
L23: Trailer truck end distance: executed	0.0
L24: Body centre of gravity before wheel centre of last axle	0.0
L30: Distance to centre of coupling	5488.0
L40: Vehicle overhang rear	1480.0
L41: Vehicle overhang theoretical, rear	1480.0
L42: Total length	5823.0
L43: Body length Series	3800.0
L44: Possible body length	0.0
L45: min. body length for measurement L20	0.0
L46: Maximum body length for dimension L21	0.0
L47: perm. Body length with perm. vehicle overhang	0.0
L48: max. platform length	0.0
L49: perm. Theoretical vehicle overhang	0.0
L50: Body begins at first wheel centre	700.0

**Heights**

H01: Height above Cabin, not loaded	2593.0
H02: Height above Cabin, loaded	2544.0
H03: Frame height, unloaded	830.0
H04: Frame height, loaded	742.0
H06: Chassis clearance front	177.0
H07: Chassis clearance rear	189.0
H08: Chassis clearance between axles	181.0
H10: Lift from driving position at front	0.0
H11: Lower from driving position at front	0.0
H12: Lift from rear running position	0.0
H13: Lower from rear running position	0.0
H14: Lift the leading axle.	0.0
H15: Lift the trailing axle	0.0
H16: Centre wheel to lower edge of frame, unloaded	230.0
H17: Centre wheel to lower edge of frame, loaded	162.0
H20: Trailer truck aux. frame	0.0
H21: Trailer truck coupling mounting plate	0.0
H22: Trailer truck height without coupling, not loaded	0.0
H23: Trailer truck height without coupling, loaded	0.0
H24: Construction height Fifth wheel, assumed	0.0

H25: Fifth wheel unloaded above ground	0.0
H26: Fifth wheel loaded above ground	0.0
H27: Upper edge of tyres to semitrailer upper edge, lowered	0.0
H30: Chassis height, series	320.0
H31: Loading surface is not loaded	1150.0
H32: Loading surface is loaded	1062.0
H33: Front wall height, series	700.0
H34: Platform gate height, series	400.0

**Widths**

B01: Cab width overall	2240.0
B02: Width above rear wheels	2184.0
B03: Overall width	2300.0
B04: Frame width, front	959.0
B05: Frame width, rear	859.0
B20: Body width series	2350.0

**Weights**

G01: Perm. Axle load 1. Axle	3400.0
G02: Perm. Axle load 2. Axle	5200.0
G03: Perm. Axle load 3. Axle	0.0
G04: Perm. Axle load 4. Axle	0.0
G05: Perm. Axle load 5. Axle	0.0
G09: Perm. Total weight	7490.0
G50: Chassis weight with cab	3500.0
G51: Chassis weight front	2655.0
G52: Chassis weight rear	845.0
G53: Load capacity / semitrailer load	3990.0
G54: Empty weight with series body	4410.0
G55: Net cargo	3080.0
G56: weight of plant pallet	910.0
G60: Perm. train weight	18750.0
G61: Perm. trailer load	11260.0

**Circular dimensions and radii**

K01: Turning diameter in m	10.7
K02: Turning circle diameter in m	12.4
R01: Pivoting diameter front	0.0
R02: Pivoting diameter rear	0.0

**Surface and cubic dimensions**

F01: Loading surface in m <sup>2</sup> Series	8.9
V01: Loading volume in m <sup>3</sup> series	3.6

**Drawing no and frame profile**

BLN:	1
PNR: Frame profile number	36
ZNR: Drawing number	85.99126.0020

The specified technical data relates to the vehicle's standard equipment (not taking into account the selected special equipment).

Chassis weight: weight of the entire chassis incl. 1 driver, tools and full fuel tank.

Tolerances according to chassis drawing (see above for drawing number; download from [www.manted.de](http://www.manted.de)).